

TR



TR



60 ▶ 120 HP



2000 ▶ 2800



40-90 mm



70 mm



Heavy

FIXED VERSION

Heavy fixed stalk shredder for tractors from 60 to 120 HP with working widths from 200 to 280 cm for open field crops.

Gearbox made by SICMA, with tapered roller bearings, integrated freewheel, caps for oil input and discharge and level cap

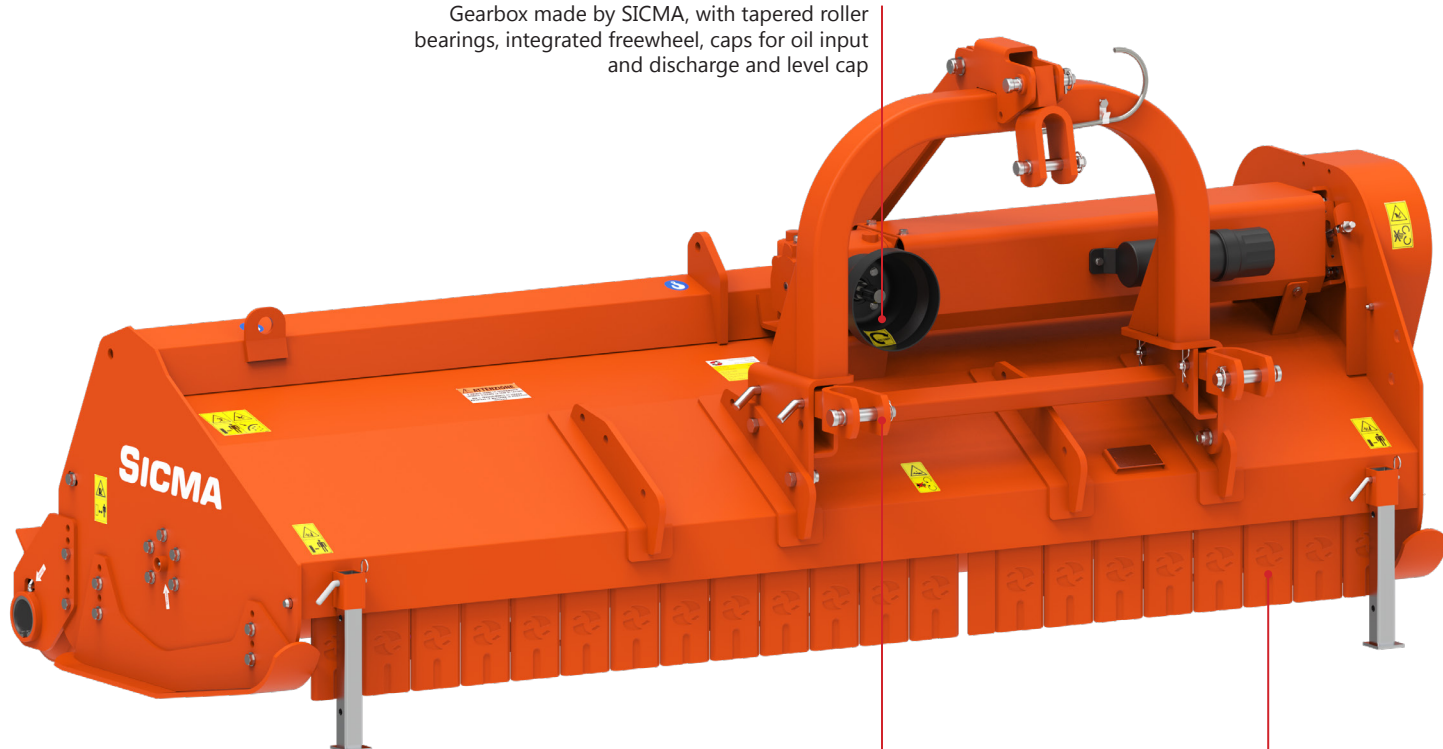

Double working position:
centred or offset (280 mm)
fixed version

Front protective guards
against accidental
ejection of objects

TECHNICAL DATA

Reducer speed:

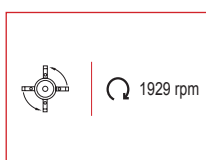
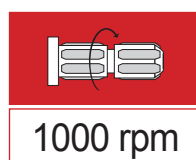
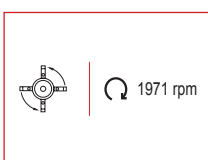
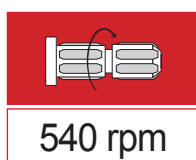

Models and Features:

	HP	mm (in)	mm (in)	mm (in)	kg (lbs)	nr.	nr.		cat.
TR 200	60 ▶ 120	2000 (79")	2160 (85")	340 (13")	688 (1514)	44	22	4	2
TR 225	60 ▶ 120	2250 (49")	2430 (93")	340 (13")	760 (1672)	48	24	4	2
TR 255	60 ▶ 120	2550 (100")	2695 (106")	340 (13")	832 (1830)	56	28	4	2
TR 280	60 ▶ 120	2800 (110")	2965 (117")	340 (13")	904 (1989)	60	30	4	2

MOVABLE VERSION



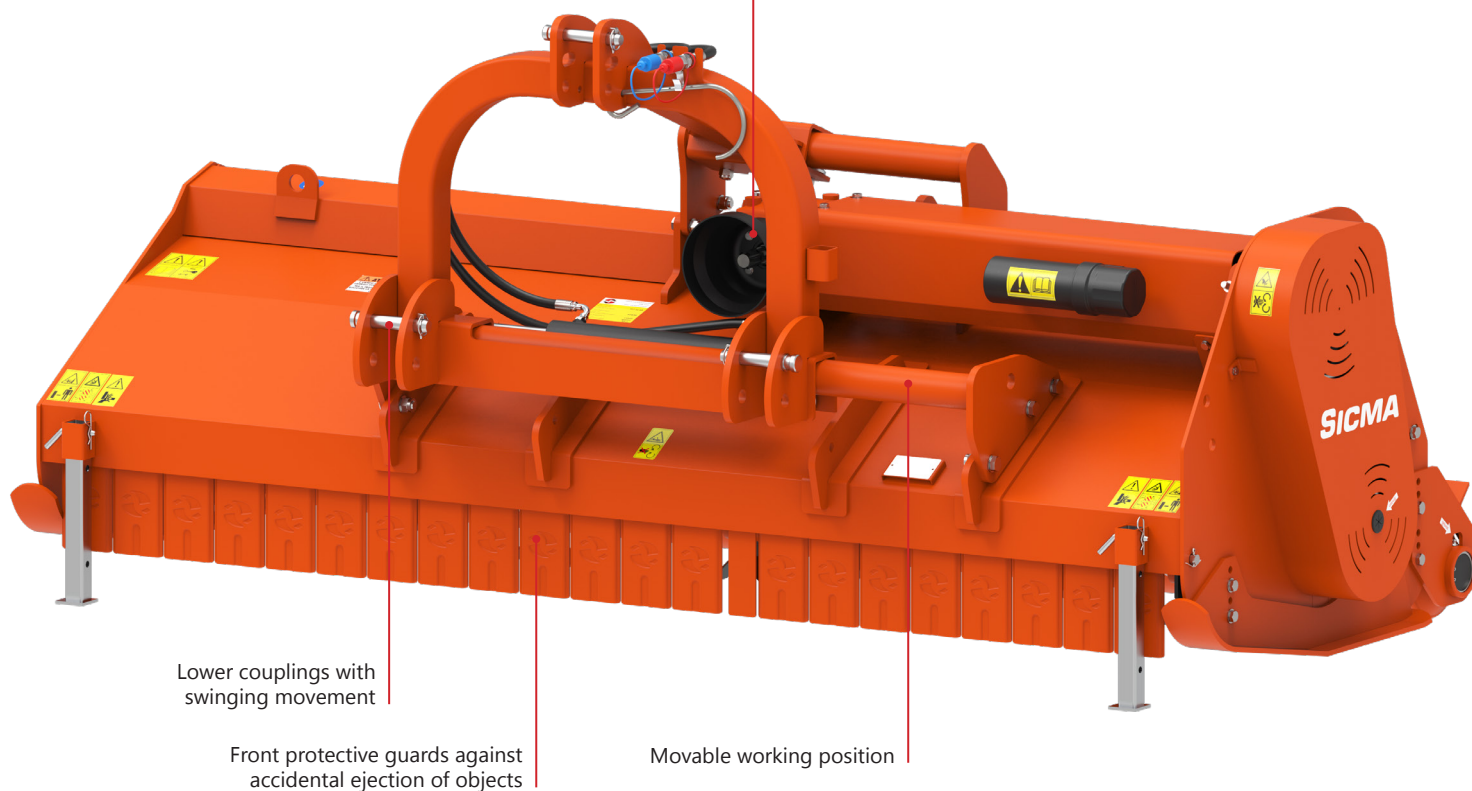

Heavy duty movable stalk shredder for tractors from 60 to 120 HP with working widths from 200 to 280 cm for open field crops.

Gearbox made by SICMA, with tapered roller bearings, integrated freewheel, caps for oil input and discharge and level cap



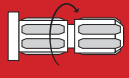

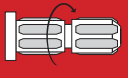

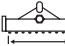
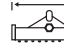

TECHNICAL DATA

Reducer speed:

			
540 rpm	1971 rpm	1000 rpm	1929 rpm

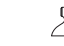
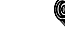
Models and Features:

	 HP	 mm (in)	 mm (in)	 mm (in)	 kg (lbs)	 nr.	 nr.	 nr.	 cat.
TR 200	60 ► 120	2000 (79")	2160 (85")	340 (13")	688 (1514)	44	22	4	2
TR 225	60 ► 120	2250 (49")	2430 (93")	340 (13")	760 (1672)	48	24	4	2
TR 255	60 ► 120	2550 (100")	2695 (106")	340 (13")	832 (1830)	56	28	4	2
TR 280	60 ► 120	2800 (110")	2965 (117")	340 (13")	904 (1989)	60	30	4	2

EUROCARDAN
ENERGY ON THE MOVE



Universal shaft
(Eurocardan) size 6



POLYESTER
POWDER COATING

Transmission with
V-belts and manual
belt tensioner system

Openable cover in the
knife version (not available
for the European Union)

Partially boxed
frame

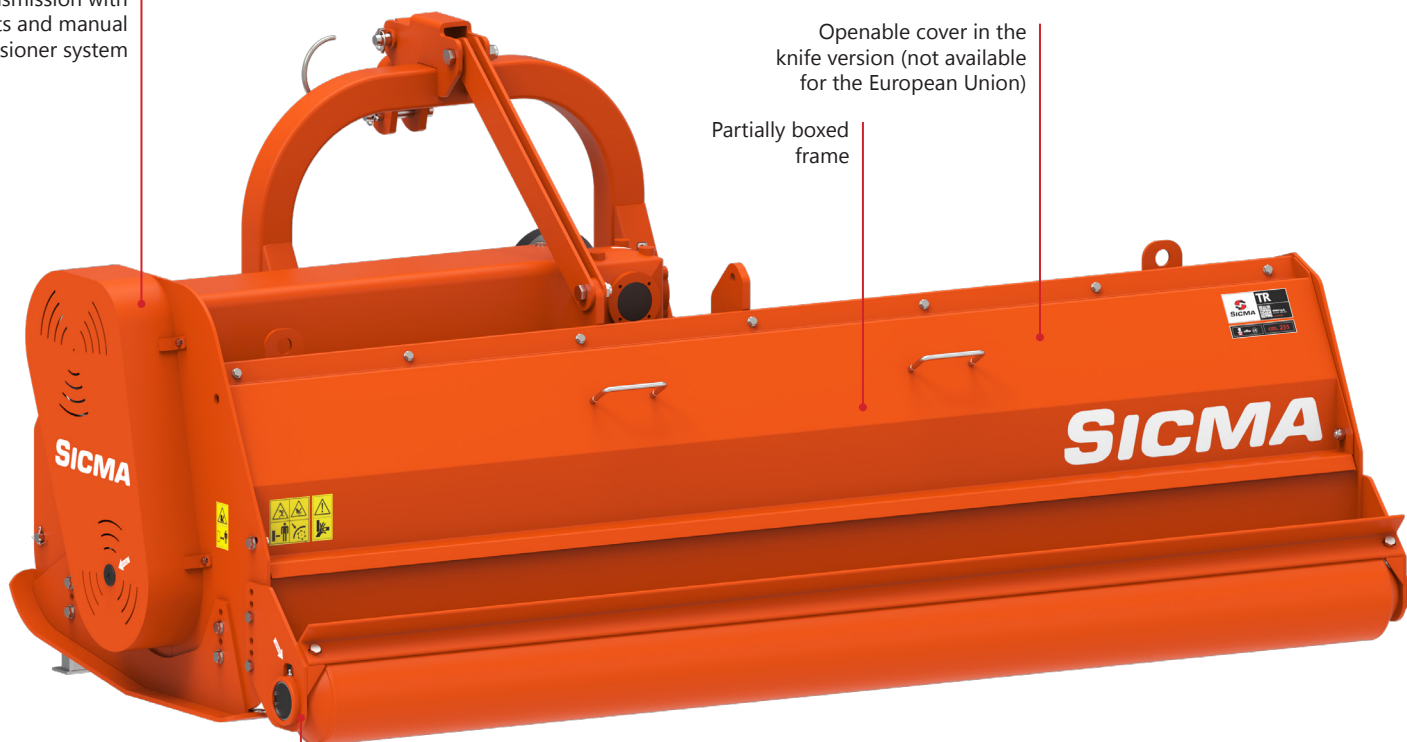

Rear stabiliser roller bearings
shielded and protected from
contact with external agents
(soil, grass, pruning waste)

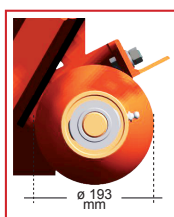
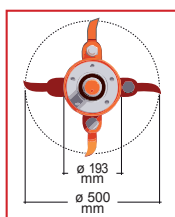

Object launch
protection blades

Transmission with V-belts and
manual belt tensioner system

Rotor supports with high reliability
bearings equipped with NILOS
lubricant seals

High resistance self-
centring pulley shrink
discs

Helical shaft

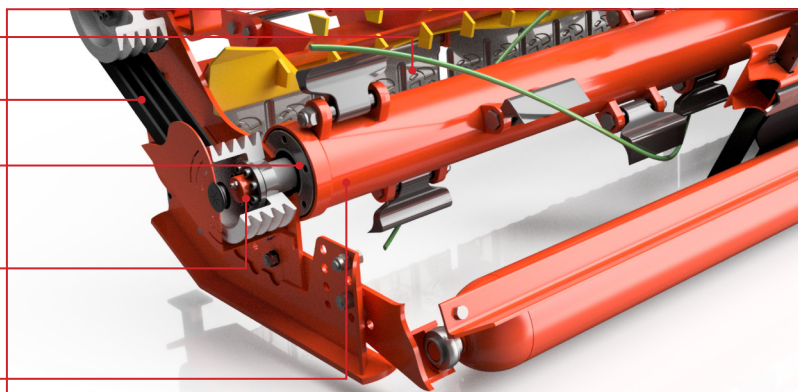

ROTOR AND TOOL VERSIONS

The perfect operation of the shredder largely depends on the rotor, an essential component of a high-performance machine, as its rotation allows the tools to shred grass or pruning residues. The most important

characteristics of the rotor (excluding the width as bulk and weight) are undoubtedly the thickness of the steel used and the diameter.

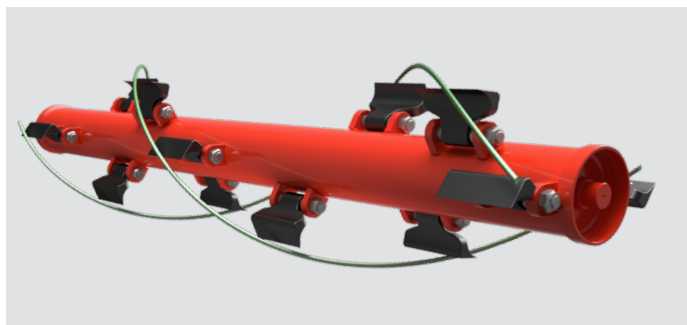

HELICOIDAL SMOOTH HAMMERS

For grass, shrubs, lawn maintenance; vines, medium-sized pruning; pruning of woody residue from vineyards and olive groves.

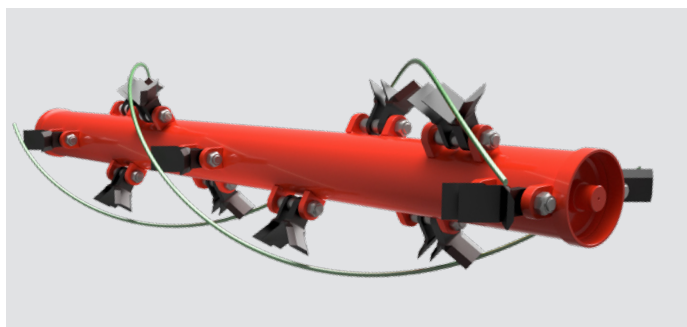
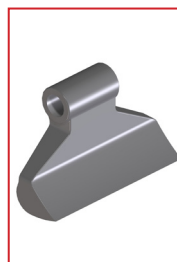

HELICOIDAL KNIVES

For grass, shrubs, lawn maintenance; vine shoots, straw, stalks.

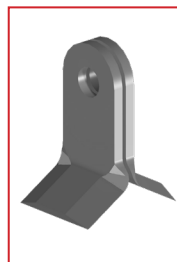

ACCESSORIES



Rubber swivelling wheel to replace roller

Ideal for stony soils and does not compact the ground like a roller.

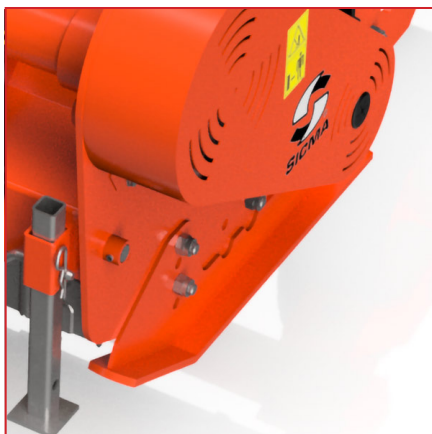

Side skids

They allow the adjustment of the working height.



Hydraulic cylinder for shifting

It is used to move the flail mower sideways with a jack without getting off the tractor

Available only for the movable version.



Operation at 1000 rpm

Possibility to equip the machine with belts and pulleys for operation at 1000 rpm



*The experience that cultivates
the future of your land*

SICMA S.p.a. is an Italian company and a leader in
the professional agricultural machinery sector.
We design and create cutting-edge solutions for
you, the farmer of tomorrow. Innovation and
passion at your service.



MIGLIANICO | ABRUZZO | ITALY

Sicma SpA

Contrada Cerreto, 39
66010 Miglianico (CH)
Tel. +39 0871 95841

info@sicma.it - www.sicma.it

